

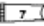

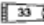

-  Loctite "271" Adhesive Sealant (92-809819)
-  Loctite "RC/660" Retaining Compound (92-809833)

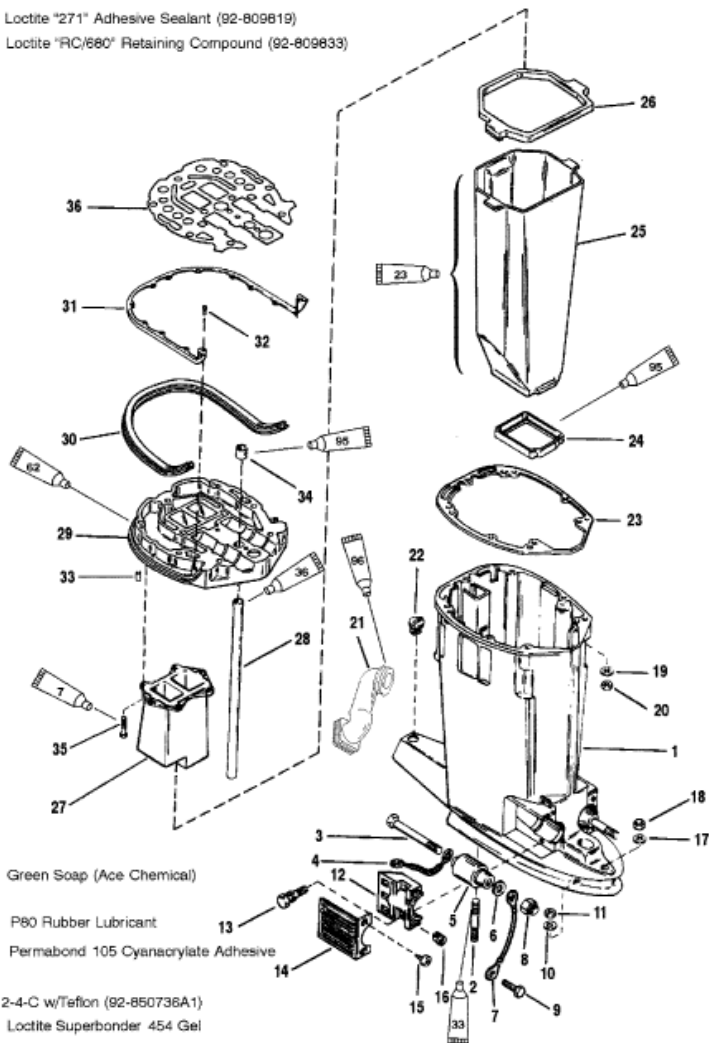
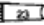

-  Green Soap (Ace Chemical)
-  P80 Rubber Lubricant
-  Permabond 105 Cyanoacrylate Adhesive
-  2-4-C w/Teflon (92-850736A1)
-  Loctite Superbonder 454 Gel

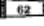
				Parts List		
Ref	Class	Part	Description	Qty	Comment	Footnote
1	1590	8343T10	DRIVE SHAFT HOUSING	1	(LONG)	
1	3503	813563T 1	DRIVE SHAFT HOUSING	1	(X-LONG)	
2	16	56295	STUD	2		
3	10	63474	SCREW (1/2-20 X 6 IN.)	2		
4		88238A10	GROUND WIRE	1		
5		77327	LOWER MOUNT	2		
6	12	49339	WASHER	2		
7		88238A10	GROUND WIRE	1		
8	11	826708 17	NUT	2		
9	10	41508	SCREW (1/4-20 X 3/8 IN.)	1		
10	12	45176	WASHER	2		
11	11	826710 15	NUT	2		
12	54	67076	CLAMP	2		
13	10	66727	SCREW (5/16-18 X 1-1/4 IN.)	4		
14		67077T	COVER	2		
15	10	88417	SCREW (12-24 X 5/8 IN.)	4		
16	11	35521	NUT	4		
17	12	48926	WASHER	1		
18	11	826710 15	NUT	1		
19	12	20553	WASHER	4		
20	11	69254	NUT	4		
21		828212	IDLE EXHAUST BOOT	1		
22	19	64649	PLUG	1		
23	27	99173 4	GASKET	1		2
24		66350	SEAL (LOWER)	1		
25		18276	EXHAUST TUBE	1		
26		17726 1	SEAL (UPPER)	1		
27		812834 1	EXHAUST EXTENSION	1	(150)	
27		41942 4	EXHAUST EXTENSION	1	(135/115)	
28	32	67295	WATER TUBE	1	(LONG)	
28	32	74729	WATER TUBE	1	(X-LONG)	
29		18233A 8	PLATE ASSEMBLY	1		
30		814701 2	SEAL	1		
31		68011	BRACKET	1		
32	10	812832	SCREW (10-16 X 1/2 IN.)	12		
33	17	43044	DOWEL PIN	2		
34	26	38970	SEAL	1		2
35	10	90192	SCREW (1/4-20 X 3/4 IN.)	6		
36	27	18307 6	GASKET	1		2
-	27	814754A00	ENGINE GASKET SET	1		